



**\*\*AVAILABLE IMMEDIATELY\*\***

**\*\*UNFURNISHED\*\* \*\*BRAND NEW SHOWER ROOM\*\*** An immaculate apartment located on the ground floor of this prestigious 1930's 'Art-Deco' style mansion block. Close to the shops of Gosforth High Street and within Gosforth's Conservation Area, Moor Court is ideally located on Westfield, Gosforth.

The accommodation briefly comprises; a very well maintained communal entrance hallway, with secure telephone entry system and lift access to all floors. Once in the apartment, you enter into a stunning open plan reception with views out onto the Town Moor. There is laminate wood flooring throughout the lounge and kitchen area, the kitchen itself is modern in style with integrated appliances and a breakfasting bar. There is a newly fitted shower room WC with step in shower, wash hand basin and WC. There are two small double bedrooms, similar in size. With gas central heating, double glazed windows and off street residents' parking externally.

A fantastic property not to be missed, ideal for either a professional couple or single occupant.

Available Immediately | £950pcm | 1930's Mansion Block | 652 Sq. Ft (60.6 m<sup>2</sup>) | Gosforth Conservation Area | Ground Floor Apartment | Two Bedrooms | Open Plan Lounge/ Kitchen Reception | Brand New Shower Room WC | Communal Lift Access | Residents' Off Street Parking | Telephone Entry | Unfurnished | GCH & DG | Council Tax Band: A | EPC Rating: D

**£950 PCM**



GROUND FLOOR  
652 sq.ft. (60.6 sq.m.) approx.

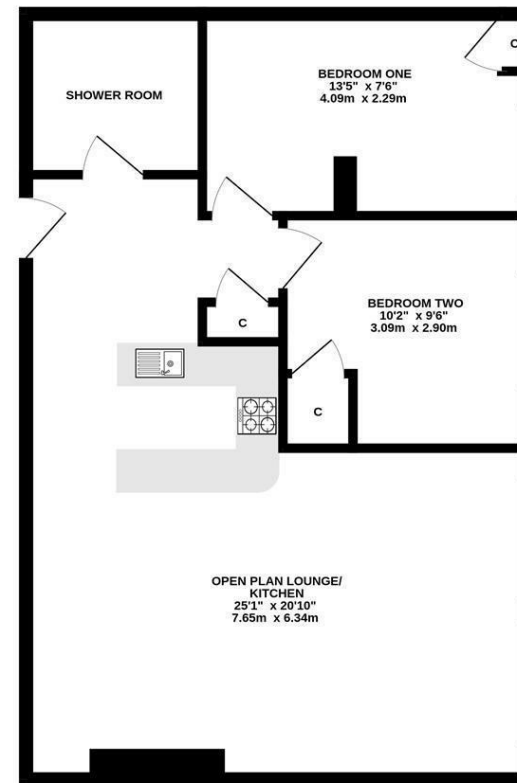

TOTAL FLOOR AREA - 652 sq.ft. (60.6 sq.m.) approx.  
Whilst every attempt has been made to ensure the accuracy of the floorplan contained here, measurements of doors, windows, rooms and any other items are approximate and no responsibility is taken for any error, omission or mis-statement. This plan is for illustrative purposes only and should be used as such by any prospective purchaser. The services, systems and appliances shown have not been tested and no guarantee as to their operability or efficiency can be given.  
Made with Metropix ©2026



**IMPORTANT NOTE:** These particulars and the descriptions and measurements herein do not constitute representation and whilst every effort has been made to ensure accuracy, this cannot be guaranteed.

